

REVISION HISTORY OF: 020-001243-01			
REV	DESCRIPTION OF CHANGE	BY	REV DATE
01	INITIAL RELEASE	RF	04/17/2017

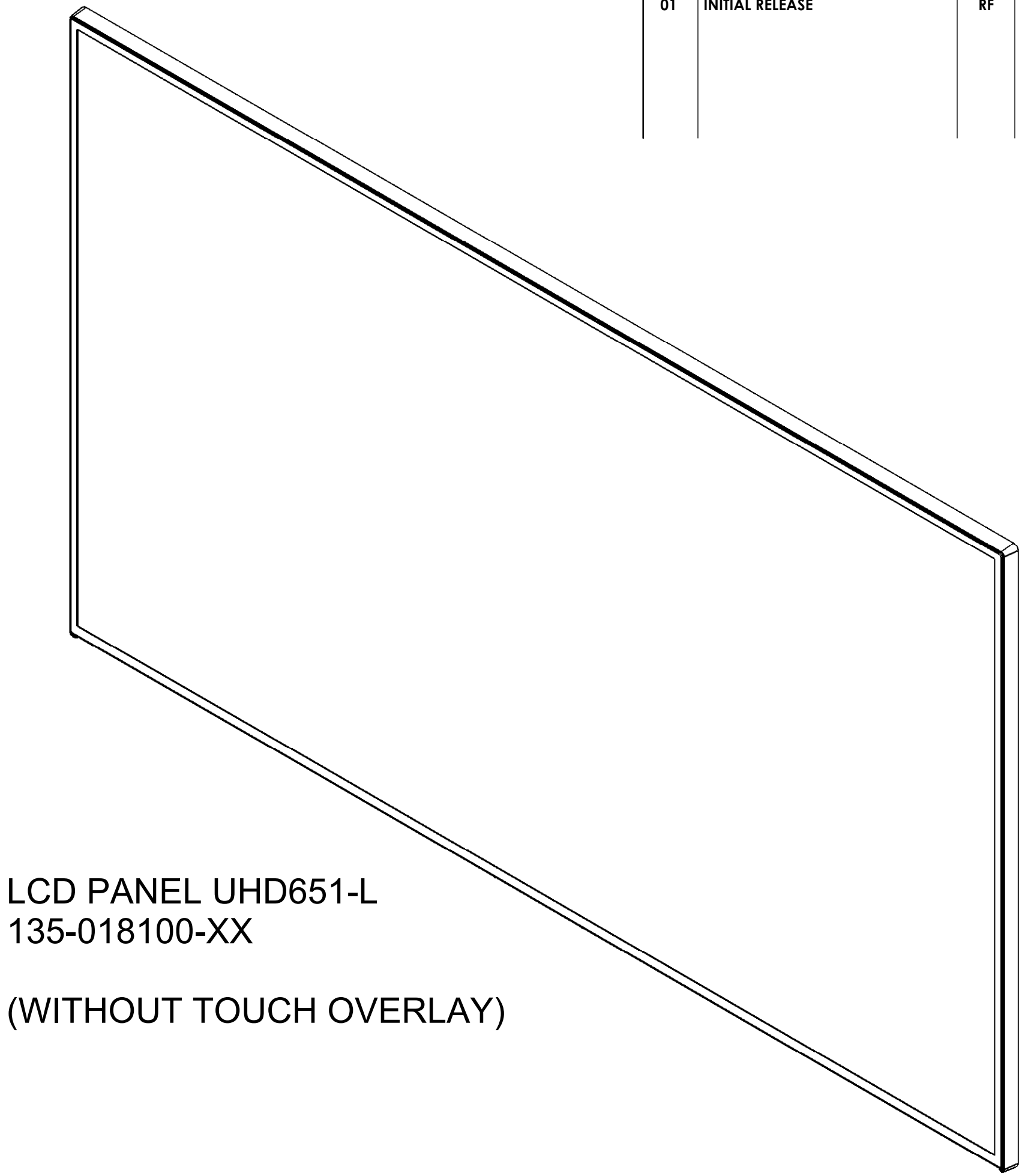

LCD PANEL UHD651-L  
135-018100-XX  
(WITHOUT TOUCH OVERLAY)

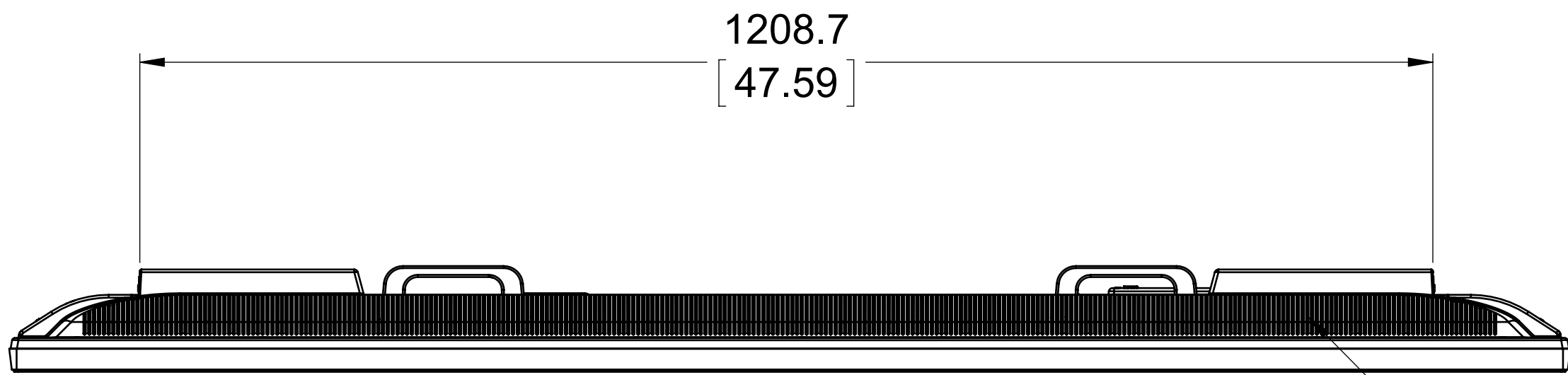

DO NOT OBSTRUCT  
AIRFLOW  
(ALL INSTANCES)

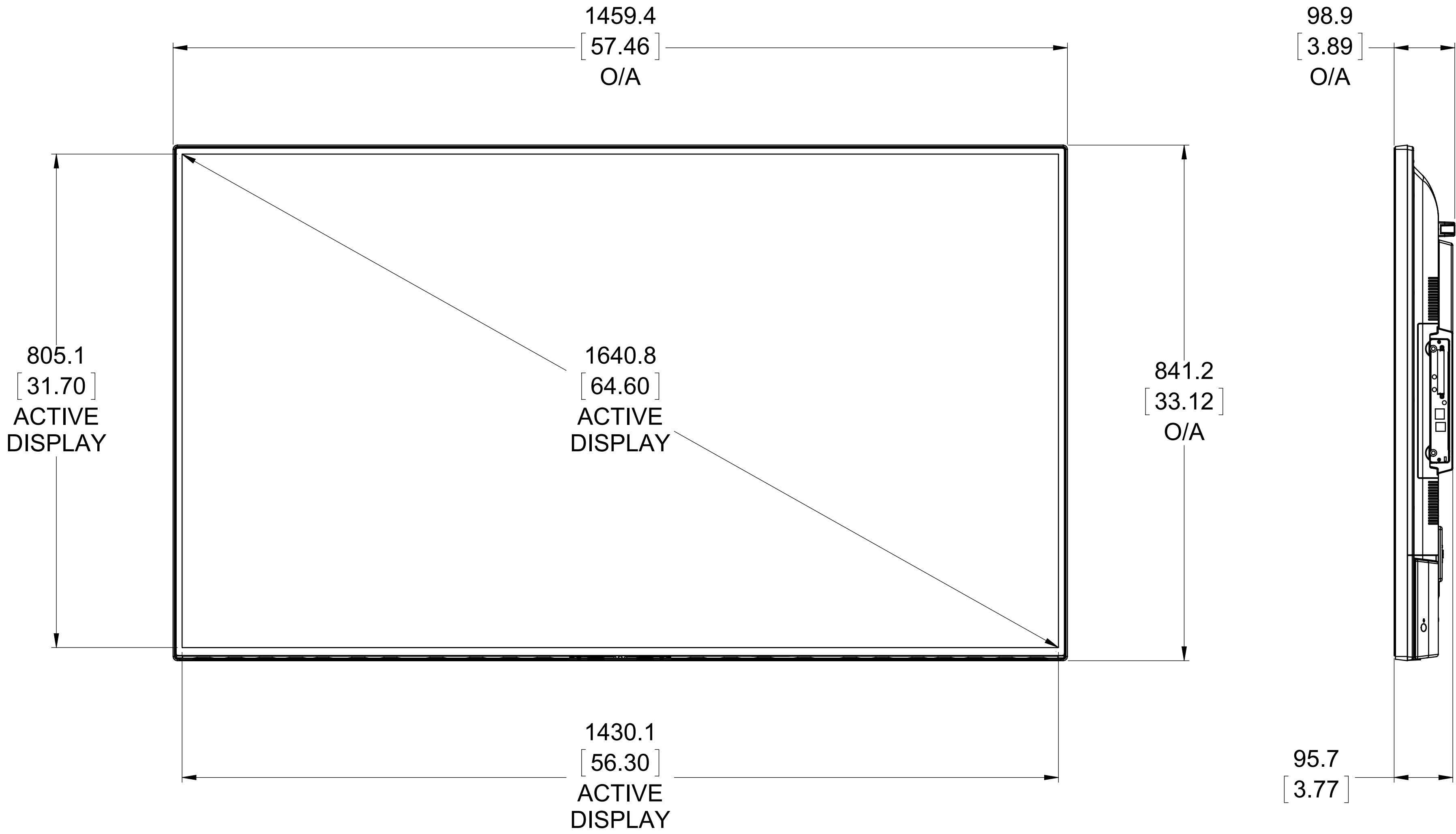

DO NOT OBSTRUCT  
AIRFLOW  
(ALL INSTANCES)

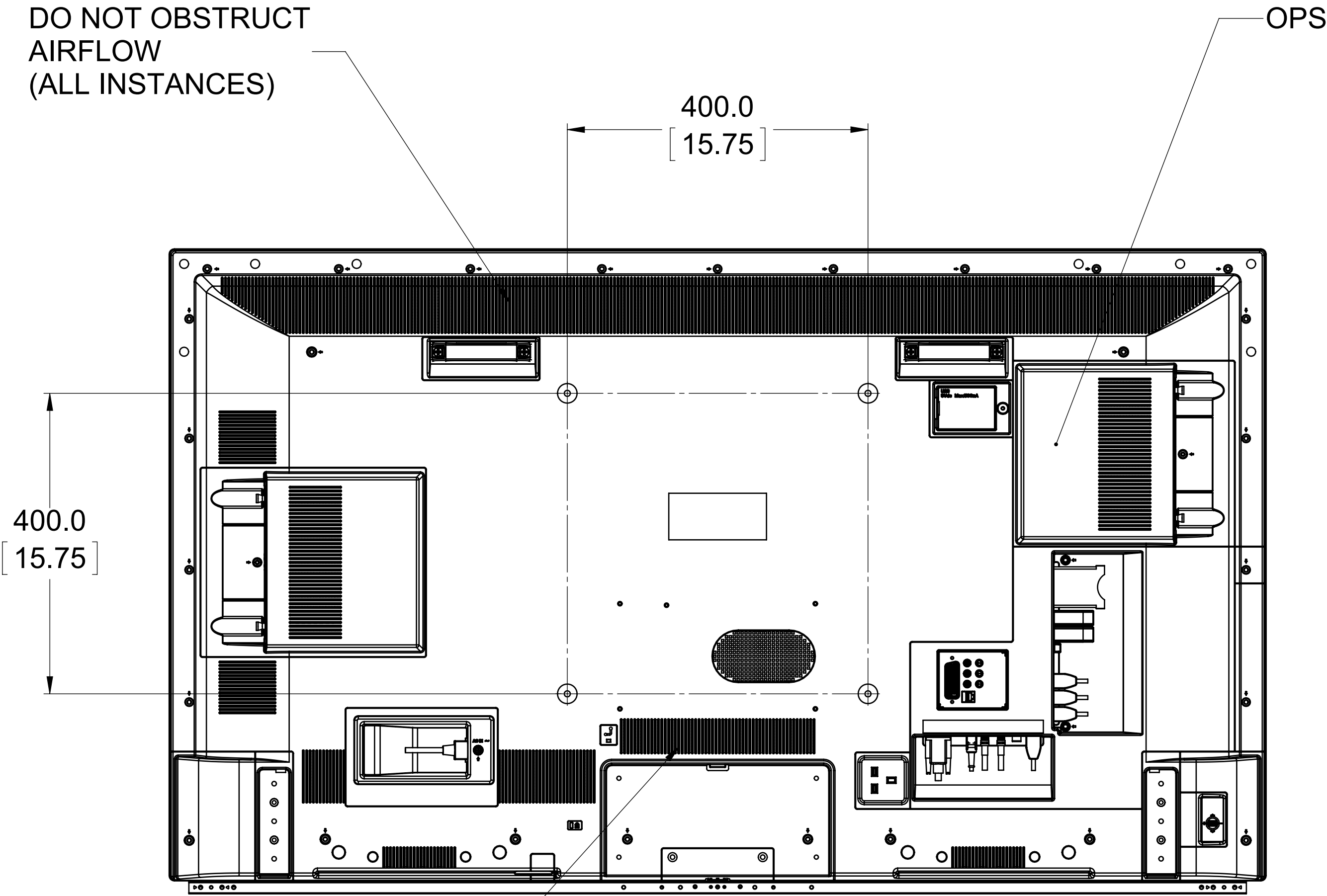

DO NOT OBSTRUCT  
AIRFLOW  
(ALL INSTANCES)

GENERAL NOTES:

MASS: 24.7 ± 0.5 kg (54.3 ± 1.1 lbs)

OPERATING TEMPERATURE: 0 - 40°C (32 - 104°F) MAX.

MAX. POWER REQUIREMENTS: 140W (NOT INCLUDING OPS)

TYPICAL POWER CONSUMPTION: 73.0W (NOT INCLUDING OPS)

STANDBY POWER CONSUMPTION: ≤ 0.5W (NOT INCLUDING OPS)

TO ENSURE THE MOUNTING BRKT CLEARS ANY PROTRUSION ON THE REAR OF THE PANEL, CHRISTIE RECOMMENDS USING SPACERS WITH A MINIMUM HEIGHT OF 6.35MM (.25IN)

UNITS		INCHES		MILLIMETRES		DRAWN BY		E. FARBER		DRAWN DATE		04/17/2017		APPROVED BY		L. MCQUEEN		APPROVAL DATE		05/16/2017		TOLERANCES APPLY AS SHOWN BELOW		DECIMAL PLACES		INCHES		MILLIMETRES		XXX		± .003		± 1.6		XX		± .125		± 3.1		X		± .250		± 6.3		ANGULAR DIMENSIONS		XX°		± 1.0°		XX.X°		± 0.5°		THIRD ANGLE PROJECTION		PART DESCRIPTION		DWG LINE UHD651-L		SIZE		E		PART NUMBER		020-001243-01		SHEET 1 OF 2		01		MASS		- LBS [ KG ]		CHRISTIE DIGITAL SYSTEMS USA, INC. CHRISTIE DIGITAL SYSTEMS CANADA, INC.	
-------	--	--------	--	-------------	--	----------	--	-----------	--	------------	--	------------	--	-------------	--	------------	--	---------------	--	------------	--	---------------------------------	--	----------------	--	--------	--	-------------	--	-----	--	--------	--	-------	--	----	--	--------	--	-------	--	---	--	--------	--	-------	--	--------------------	--	-----	--	--------	--	-------	--	--------	--	------------------------	--	------------------	--	-------------------	--	------	--	---	--	-------------	--	---------------	--	--------------	--	----	--	------	--	--------------	--	---	--

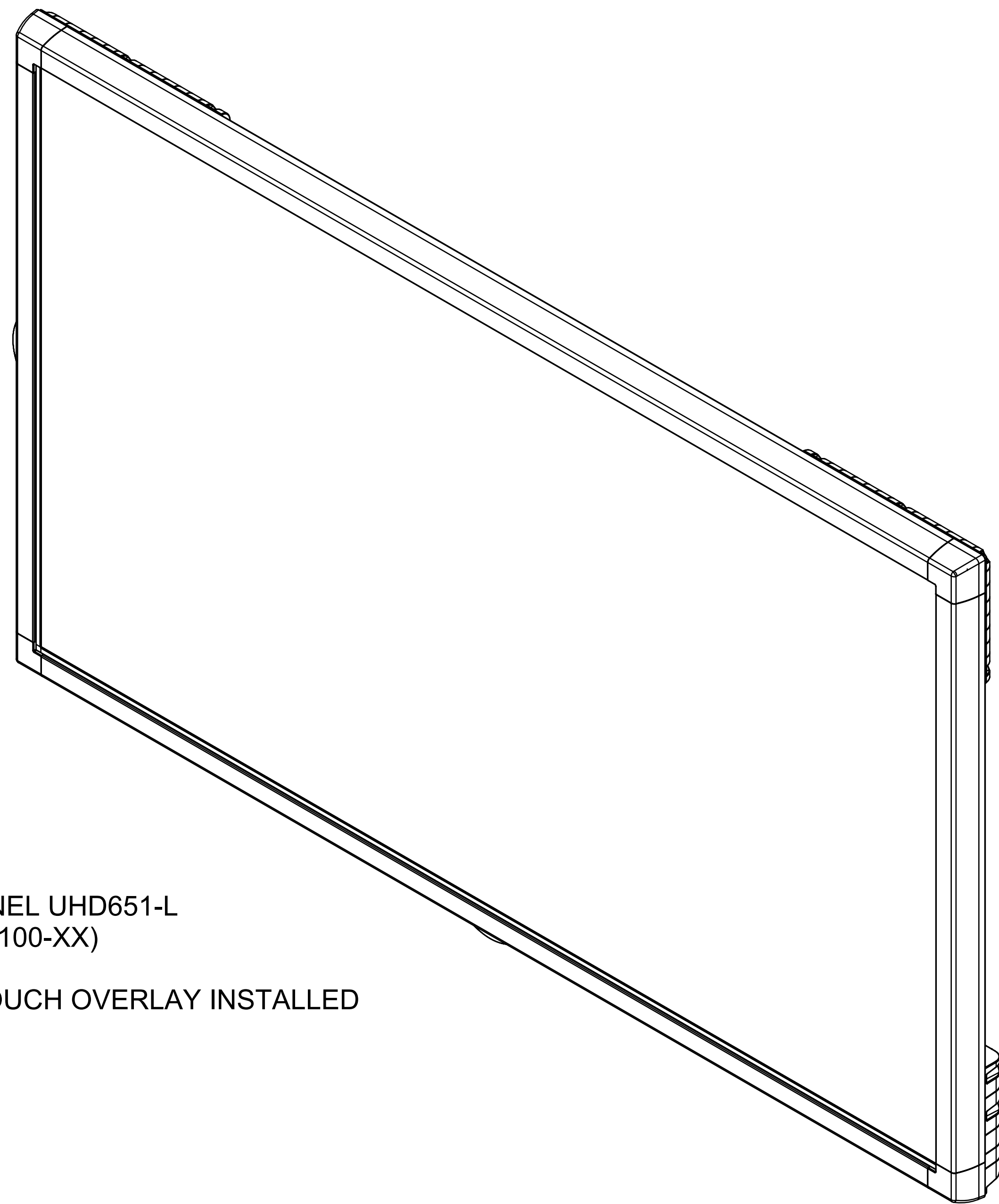
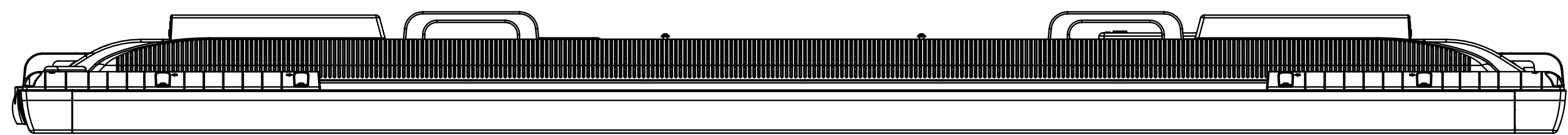

LCD PANEL UHD651-L  
(135-018100-XX)  
WITH TOUCH OVERLAY INSTALLED

